



30 Wattle Grove, Loch Sport

ONLY A SHORT WALK FROM THE WATER EDGE WITH VIEWS OF LAKE VICTORIA!!!

This view will help you relax and unwind from the hustle and bustle of your busy life!

Location is only two streets back from the water with the walk way reserve leading down to the beach right opposite here!! Walk out the door, across the road, down the steps and through the path and you could be taking a dip at the lake!!!

This home definitely has the beach house appeal!!! On the first level you will find two good size bedrooms with built in robes and ceiling fans, laundry with a shower and separate toilet. Heading up the internal stairs are two more bedrooms with built in robes and ceiling fans, bathroom and separate toilet.

Wait till you see the spacious living area that flows out onto the balcony and continues on up onto the viewing deck!! Open the door and double the living space!!! The kitchen is modern with plenty of cupboard, bench space and the added bonus of a dishwasher! Timber floors through out the home are perfect for the beach environment!! There is also a brand new reverse cycle air conditioning to help with the hot summers days! The vendor is including most of the furniture and also offering linen and assorted kitchenware in the sale so you can walk straight in and start living the holiday dream!!

The property is also fully connected into the Loch Sport Sewerage Scheme.

Plenty of parking space here with double carport under the home and 6 x 7 metre garage at the rear of the home so why not bring the boat with you!! Plenty of water storage with the added bonus of a bore for watering the lawn and tall fencing for privacy.

So why not take a trip to the coast today and buy yourselves a holiday home, come retirement!!!

4 2 4

Land Area 537 sqm

\$355,000 Open To Offers

ID# 407

Open for Inspection

By Appointment



Rachelle Potts
(03) 5146 0946
0407 460 936

Garage
6200 x 7250

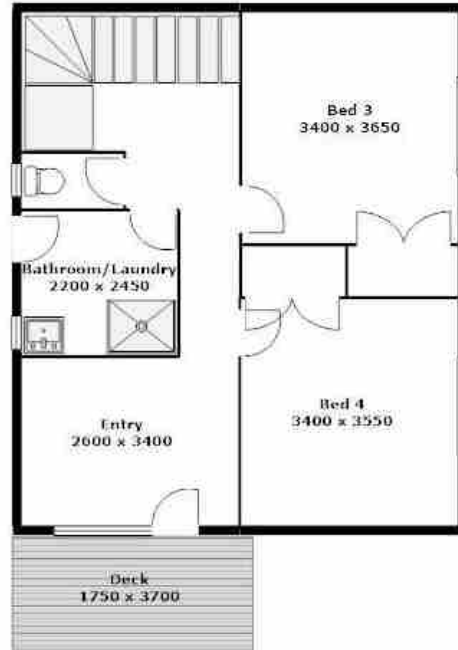

Carport
6000 x 6800

**PLEASE NOTE THAT ALL MEASUREMENTS ARE APPROXIMATE & NOT TO EXACT SCALE



*** PLEASE NOTE THAT ALL MEASUREMENTS ARE APPROXIMATE & NOT TO EXACT SCALE