



31 Central Avenue, Loch Sport

WHY NOT COME AND LIVE BY THE WATER!!!

If you are looking for your forever home then look no further than what is being offered here!! This beautiful elevated home has been cared for inside and out by the current owners and is now looking for it's next owner to love it, just as much!!

On entering this home you are greeted by bright, open plan living with cathedral ceilings that make this area feel even bigger than it already is!! The kitchen is ample in size and offers a great amount of cupboard space with the added bonus of a dishwasher as well!!

The living area also has a wood heater central to the living and dining, adding to the cosiness of the home! Heading down the landing into the hallway are two spacious bedrooms to the right of the home with built in robes and third room on the left hand side, also with built in robe. The bathroom is spacious in size with the added bonus of a bath tub!! The separate laundry and toilet also offers rear access to the backyard!!

Heading outside the home there is a great spacious deck off the living area with some of it partially undercover!! Underneath the front of the home is a great concreted area that can be used as another outdoor living space, with a great outlook over the low maintenance garden that surrounds the home or even a double carport!! At the rear of the property there is a bungalow waiting to be finished! Easy make over here for the handy minded!! The Bungalow offers two bedrooms and a bathroom with a shower and has already been plastered! All that needs doing is some floor coverings and a toilet in the bathroom, then invite the extended family on holidays!!

Water storage is no issue either with a great sized concrete tank and bore connected to the property!! The fully fenced yard also adds to the privacy of the home, along with the quiet street location and the reserve at the rear of the home! There is even a work shop area tucked in underneath the back end of the home with ample space for storage as well!

With an easy walk to the water edge and the shops close by, this one is definitely worth a walk through!!

Don't let this one slip by! Everything has already been done for you, just move in and enjoy paradise!!

3 1 2

Land Area 534 sqm

\$277,000

ID# 750

Open for Inspection
By Appointment



Renee Potts
(03) 5146 0946
0412 673 126

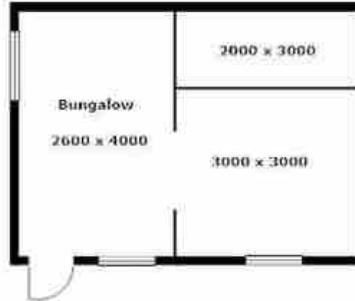

**PLEASE NOTE THAT ALL MEASUREMENTS ARE APPROXIMATE & NOT TO EXACT SCALE